

Option 1 - 23 spaces - With Tree

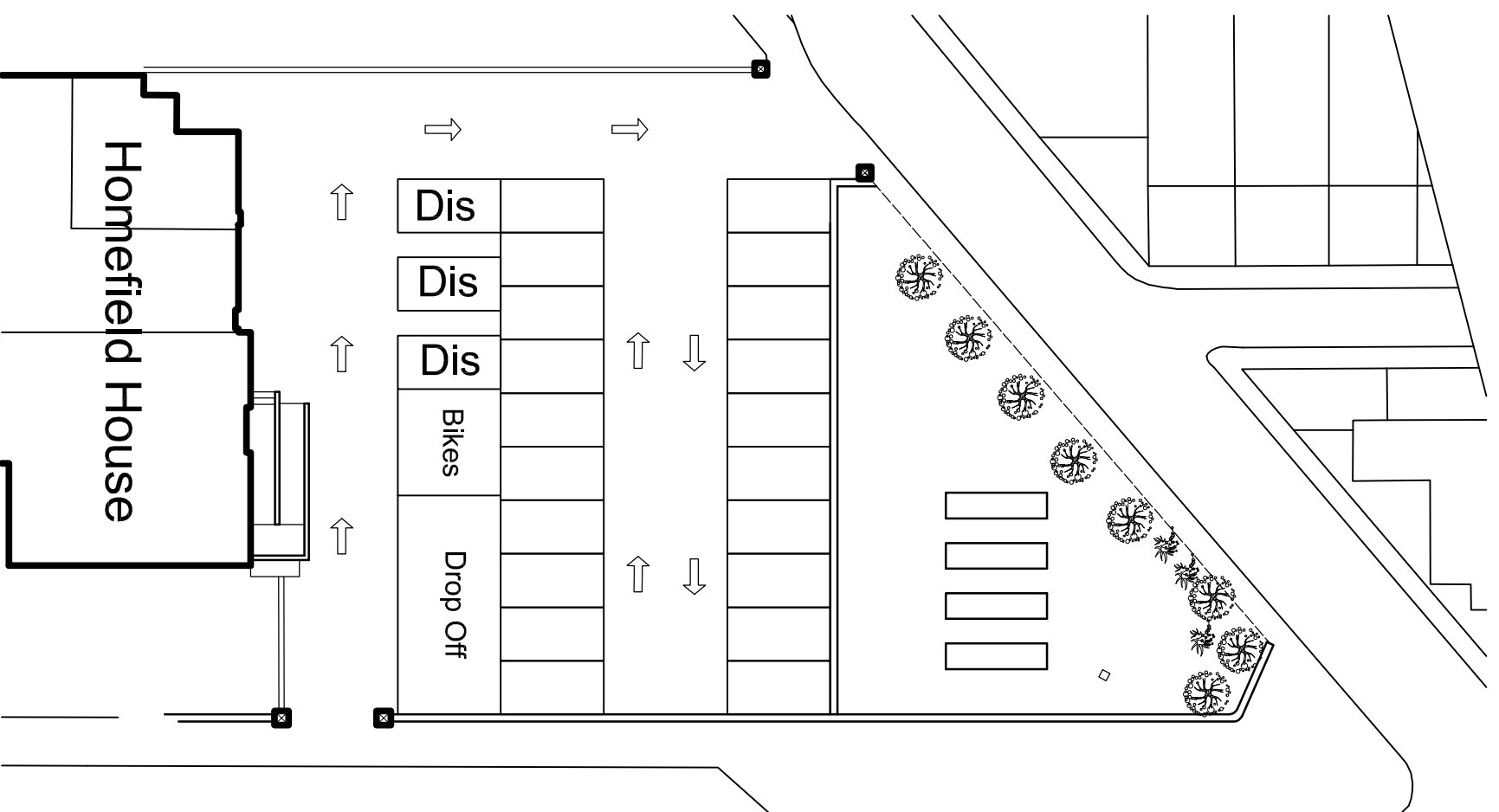

Option 2 - 23 spaces - Without Tree

Each option relies on widened gate posts 2.6m x 5m

General Notes:

- All external materials used are to match existing for size colour and texture
- All construction must be to satisfaction of Local Authority Building Inspector and must satisfy current Building Regulations

rev.	comments	date:
------	----------	-------

Holmeffield House
 Gisburn Road
 Barrowford
 Lancashire
 BB9 8ND

Project:
 CAR PARK EXTENSION

Paul Henderson
 m. 07757 389 692
 e. paul.henderson@competeadvance.co.uk

title:
OPTIONS - Alternative

status:
 For Approval

date:
 Feb'17

scale:
 NTS

drw no.:
 THREE d

drn by:
 P.H.

rev: